

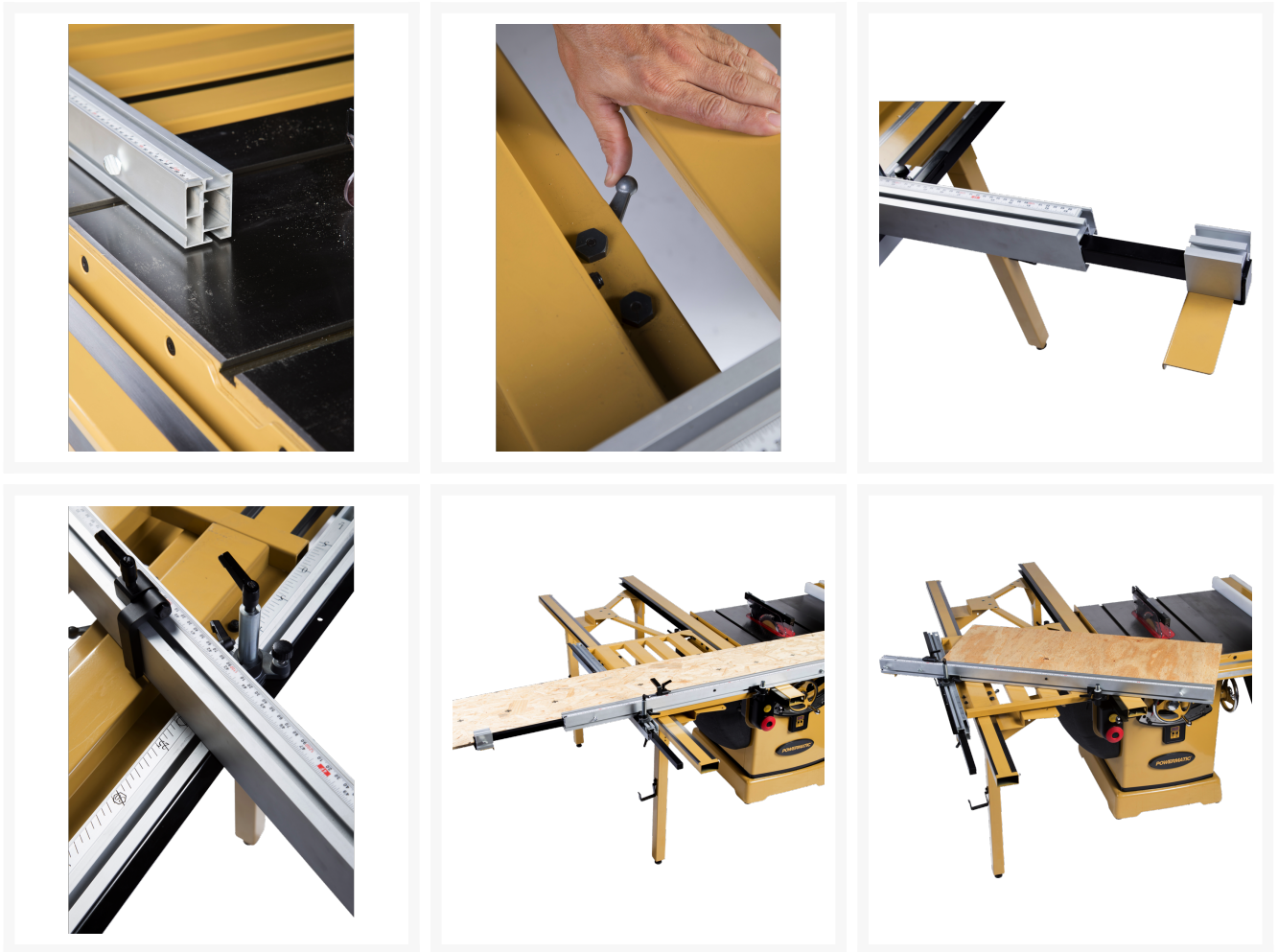

PMST-48 Sliding Table Attachment

Product Images





Description

Maximize your table saw's potential with the new Powermatic Sliding Table Saw Attachment. This large sliding table bolts to the table saw and enables smooth and precise cuts on large sheets and stock. With its precision bearing track system, the Powermatic Sliding Table Saw Attachment allows for ultimate support and controlled sliding operation while performing straight or angled cuts. The new Powermatic Sliding Table Saw Attachment is engineered to ensure precision while maximizing efficiency and performance.

Additional Information

Stock Number	PM9-1794860K
Prop 65	Cancer and Reproductive Harm
Shipping Dimensions (L x W x H) (In.)	87-13/16 x 11 x 5-1/8